

REVISIONS				
ZONE	LTR	DESCRIPTION	DATE	APPROVED
-	-	-	-	-

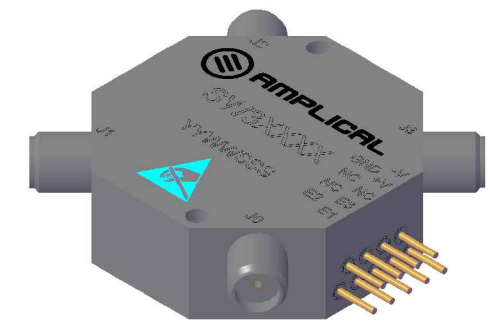
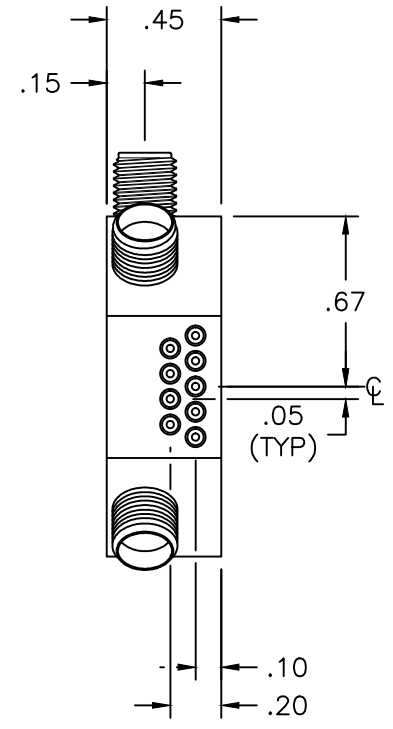
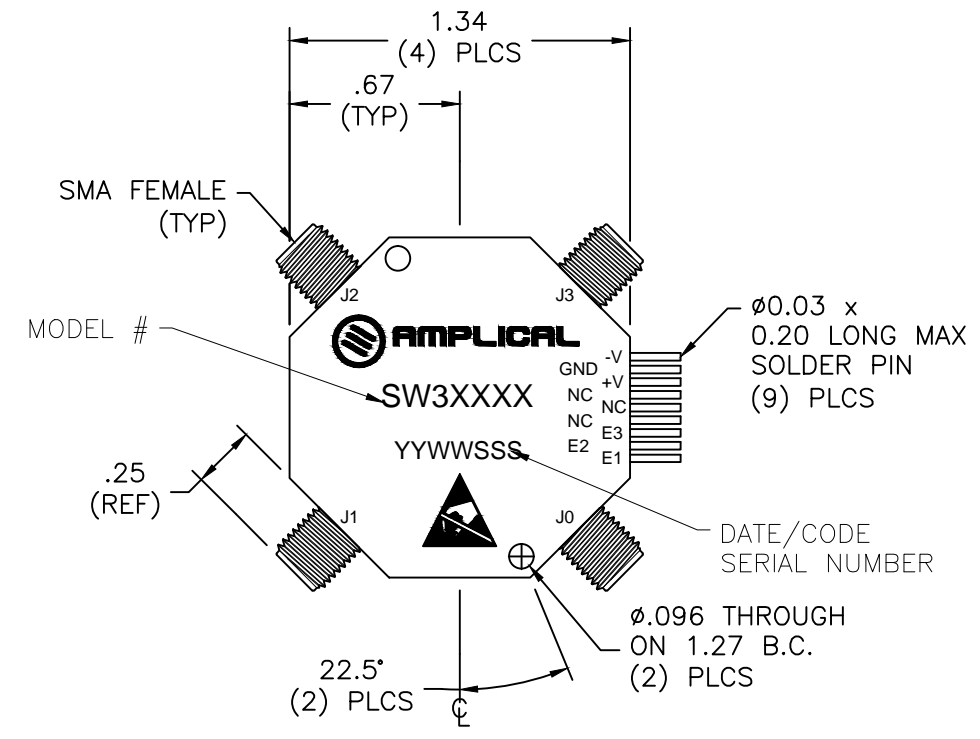

VIEW NOT TO SCALE

- NOTES:
- 1-FINISH: ALBALLOY
 - 2-CONNECTOR: SMA FEMALE PER MIL-PRF-39012, PASSIVATED STAINLESS STEEL.
 - 3-SOLDER PIN FINISH: GOLD PLATE PER MIL-PRF-45204.
 - 4-J0 IS THE COMMON PORT.
 - 5-REFER TO INDIVIDUAL PRODUCT INFORMATION DATA SHEET FOR DETAIL SPECIFICATIONS.

<p>UNLESS OTHERWISE SPECIFIED DIMENSIONS ARE IN INCHES TOLERANCES: ANGLES ± 1° DECIMALS: .XX=±.XX .XXX=±.XXX CONCENTRICITY: .004 T.I.R. SURFACE FINISH 63√ BREAK ALL EDGES</p> <p>PROPRIETARY DOCUMENT THIS DRAWING AND/OR INFORMATION OR SUBJECT MATTER CONTAINED HEREIN, SHALL NOT BE USED, COPIED OR DISSEM- INATED IN ANY MANNER, OR FOR ANY PURPOSE, OTHER THAN AS EXPRESSLY STATED BY AMPLICAL CORPORATION.</p>		SIGNED	DATE		20 TROY ROAD WHIPPANY, NJ 07981 973-386-1119 FAX 1-973-386-1131					
	DRAWN BY	AAW	5/9/15							
	CHECKED BY				TITLE	SW3-1 SWITCH OUTLINE				
	DSGN ENG APPROVAL	RG	5/9/15	PROC ENG APPROVAL	EG	5/9/15	SIZE	CODE IDENT NO	DRAWING NO	REV
	Q.A. APPROVAL	AB	5/9/15	MFG MGR APPROVAL	JH	5/9/15	B	4A1K5	OL-SW3-1	-
MODEL NUMBER	MODEL		SCALE	1.5/1	FILE NO	FILE	SHEET	X	OF	X